

How to get to SANARI-Konoeden

Please print out this sheet and show this sheet when you get TAXI.

●from Kyoto Station to SANARI／京都駅から さなり近衛殿

新町今出川を北に進み、突き当り（同志社大学新町校舎に突き当たります）を西へ。
突き当りの一軒北側が、さなりです。

First, turn to the north at “Shinmachi-Imadegawa corner”.

Second, go along the road and you can see “Doshisha-University Shinmach-Campus” at the end of the road.

Finally, turn the left (south) there and go straight. SANARI is located at the end of the road.

●from Subway Imadegawa Station to SANARI／今出川駅から さなり近衛殿 (by walk 6 minutes)

今出川駅の4番出口を出て、今出川通を西に進みます。

新町今出川を北に進み、突き当り（同志社大学新町校舎に突き当たります）を西へ。
突き当りの一軒北側が、さなりです。

Subway Imadegawa-station is nearest station. From the station to our house it takes about 6 minutes by walk.
Please exit from No.4 exit. The big street in front of you called “Karasuma street”. Then go to right way and turn the right at the big street called “Imadegawa-street”.

Go straight Imadegawa-street to west and turn right (to north) at 2nd traffic light.

(2nd traffic light is Shinmachi-Imadegawa corner)

Go along the road and you can see “Doshisha-University Shinmach-Campus” at the end of the road.

Finally, turn the left (south) at there and go straight. Sanari is located at the end of the road.

Address／住所 京のおうち さなり近衛殿

192 Konoeden-Kitaguchi-cho, Kamigyō-ku, Kyoto, JAPAN

京都市上京区近衛殿北口町 192

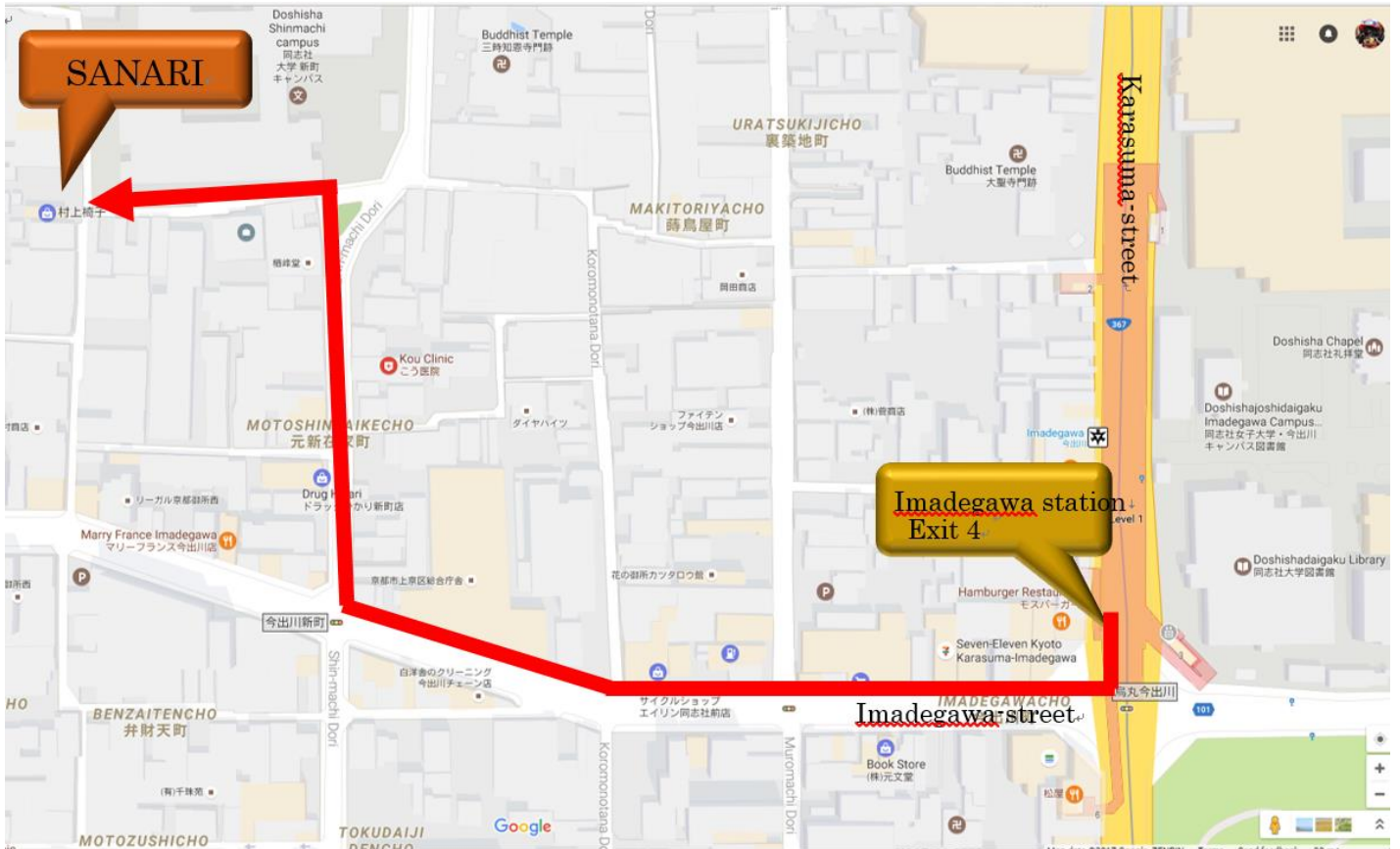

●What our house looks like
At the day time



At night



●The house drawing

We have 2locks, 1st is at the entrance. 2nd is at the door of each houses. I will tell you the number in message.

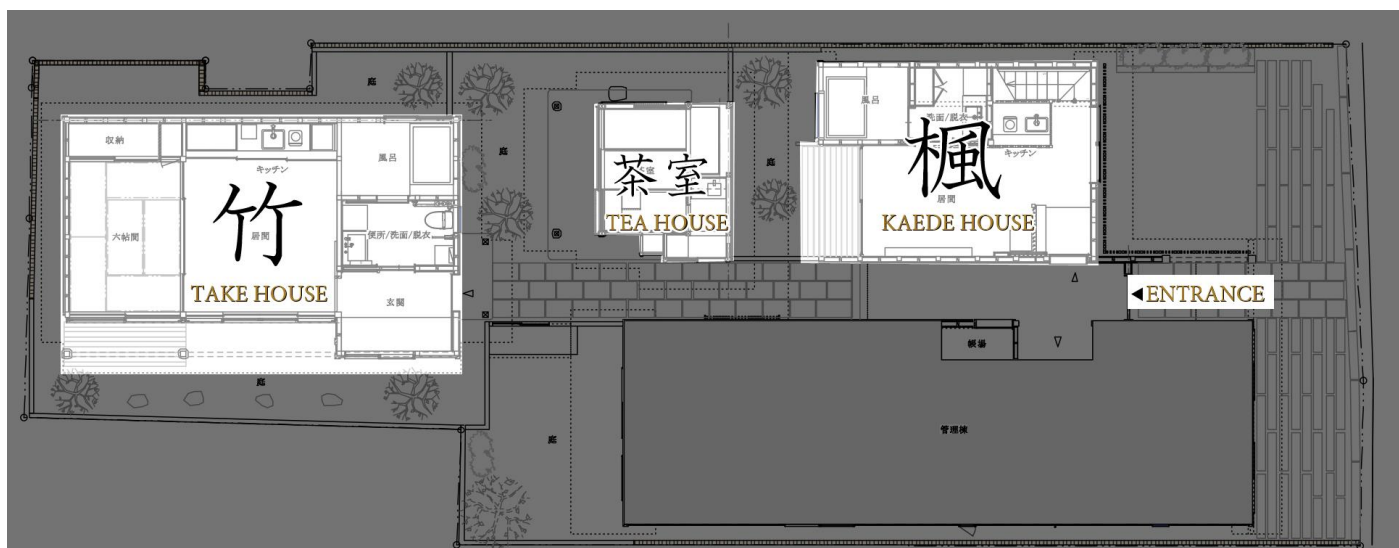

※ “TAKE HOUSE” is a one-storied house and “KAEDE HOUSE” has two stories.